

---

---

---

# RISO Printer Driver

---

---

---

## USER'S GUIDE for CV3/CV1200 Series





This document is intended for use by RISO, its authorized dealers and purchasers of the equipment described herein. While every effort has been made to insure the accuracy of information contained in this document, RISO, its authorized dealers and their employees shall not be held responsible for any inaccuracies it may contain.

ALL SPECIFICATIONS ARE SUBJECT TO CHANGE WITHOUT NOTICE.

The screens used in this manual were captured during development. Therefore, they might be different from the actual screens.

Reproduction or copying of this manual or any parts without permission is strictly prohibited.

Although every effort has been made to ensure that the contents of this manual are error-free, please contact us if you notice any errors or other points which should be brought to the company's attention.

Copyright © 2017 RISO KAGAKU CORPORATION

- Windows and Windows Vista are trademarks of Microsoft Corporation in the U.S.A. and other countries.
- Product names and company names that are referenced in this guide are (registered) trademarks of respective companies.
- The screens and content appearing in this manual may differ from the actual product.
- The screens and messages which appear in procedures may differ depending on the type of computer and application.

# Preface

---

Welcome to the high-speed PC printing field presented by RISO printers through RISO Printer Drivers.

RISO printers, which are designed to operate as high-speed GDI printers, enable you to print various documents you create on different computer platforms very quickly, but only if an appropriate RISO Printer Driver is installed on the computer.

The GDI printer uses the bit-mapped image data developed on your PC monitor screen as a print data source, enabling you to print the same image as what you see on your PC monitor screen in most cases. Additionally, it requires no printer font to print document, thus relieving you of the restrictions on the use of fonts when you create documents on your PC.

## About the Guide Signs

The following advice signs are given to the descriptions which will help a user to avoid unexpected troubles and obtain the optimum performance of this product.

- **IMPORTANT !**

Gives you helpful advice for trouble-free operation.

- **NOTE** Gives you tips for more effective use of this product.

# Procedure before printing

Before you use the printer for the first time, carry out the installation procedure below.  
After installation, follow the basic operation procedure. Then, you can print out document data.

## Installation (When the printer is used at the first time)

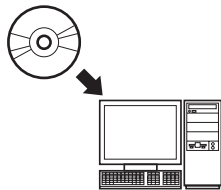

### Installing the Printer Driver

Install the RISO Printer Driver on your computer. [Page 8](#)

- Depending on the connecting method, your computer needs to be connected to the printer in advance.

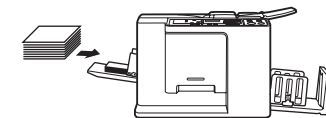

### 1. Preparing the printer

Prepare the printer and put print paper suitable for the data to be printed out onto the standard tray.

- For the preparation method for the printer, read the user's guide of the RISO printer.

#### ■ OS Support

This Printer Driver supports following OS:

##### CV3 Series

Windows Vista® (32-bit/64-bit)/Windows® 7 (32-bit/64-bit)/Windows® 8 (32-bit/64-bit)\*/  
Windows® 8.1 (32-bit/64-bit)\*/Windows® 10 (32-bit/64-bit)\*

##### CV1200 Series

Windows® 7 SP1 or later (32-bit/64-bit)/Windows® 8.1 (32-bit/64-bit)\*/Windows® 10 (32-bit/64-bit)\*

\* Only compatible with desktop app

## Basic operation

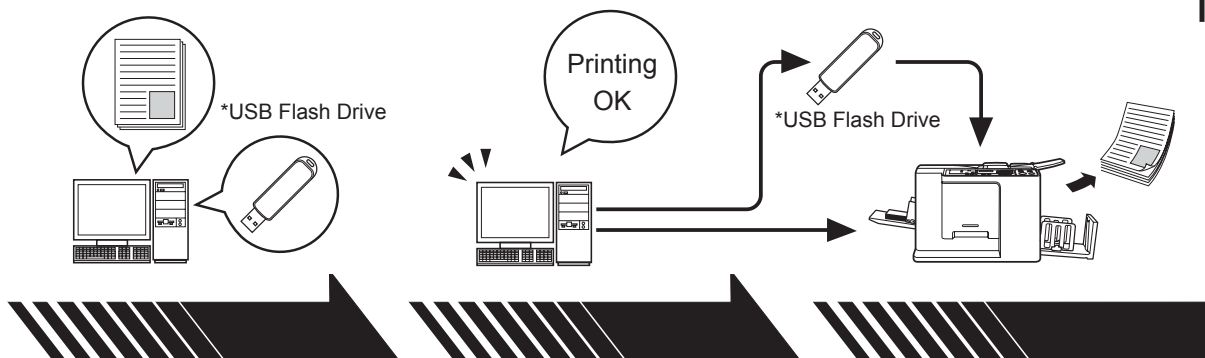

### 2. Setting

Open the data you want to print out with your computer, select your Printer Driver (or the USB flash-via-Printer Driver) and make settings for printing.

To print from a \*USB Flash Drive, connect the USB Flash Drive to your computer.

### 3. Printing

Open the [Print] dialog box on your PC and click [OK]. The data is transmitted to the printer or stored in the \*USB Flash Drive.

### 4. Completion of printing

The printer receives the data and makes a master and prints out the data.

To print from a \*USB Flash Drive, connect the USB Flash Drive to the printer.

\* Only CV3 series has a feature of printing with USB Flash Drive.

# Connecting Methods and Printer Driver types

The types of Printer Drivers are as follows:

- Printer Driver
- USB flash-via-Printer Driver

Choose the Printer Driver to install according to your environment.

## ■ When connected via cable

In the following environment, the Printer Driver should be used.

### ● When connected via USB cable [Page 9](#)

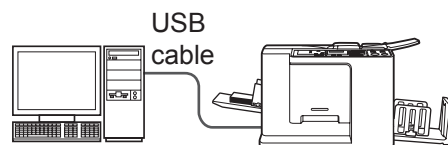

### ■ When not being connected via cable [Page 14](#)

Save the data to the USB Flash Drive with the USB flash-via-Printer Driver. Connect the USB Flash Drive to the printer to print out the data.

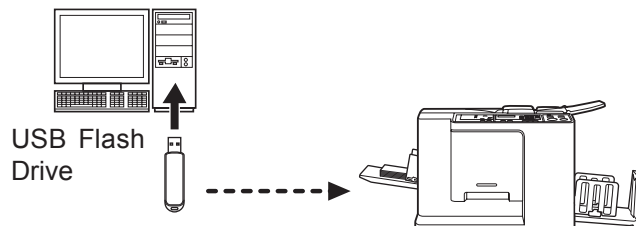

- NOTE**
- Even in the environment where the printer and your computer are connected via cable, the data can be printed with the USB Flash Drive.
  - USB Flash Driver cannot be used for the CV1200 series.

# Table of Contents

---

Preface .....	2
Procedure before printing .....	3
Connecting Methods and Printer Driver types.....	5
Table of Contents.....	6

## Installing the Printer Driver

---

■ <b>USB Connection</b> .....	<b>9</b>
Installing the Printer Driver .....	9
■ <b>USB Flash Drive Output</b> .....	<b>14</b>
About USB Flash Drives .....	14
Installing the USB flash-via-Printer Driver .....	14
Create a Folder.....	20
Printing a test page.....	21

## Working with the Printer Driver

---

■ <b>Changing the Printer Driver Configuration</b> .....	<b>24</b>
■ <b>Sending and Printing Data</b> .....	<b>27</b>
■ <b>Setting the Print Conditions</b> .....	<b>31</b>
[Basic] Tab .....	31
[Layout] Tab .....	34
[Image] Tab .....	36
[Advanced] Tab .....	39
[Option] Tab .....	41
[About] Tab.....	42

## Uninstalling the Printer Driver

---

■ <b>Uninstall the Printer Driver</b> .....	<b>44</b>
---	-----------

## Manually installing / uninstalling the Printer Driver

---

<b>For Windows Vista</b> .....	<b>48</b>
■ <b>Manual installation</b> .....	<b>48</b>
In the case of USB cable connection.....	48
In the case of USB Flash Drive output .....	50
■ <b>Manual uninstallation</b> .....	<b>51</b>
<b>For Windows 7</b> .....	<b>52</b>
■ <b>Manual installation</b> .....	<b>52</b>
In the case of USB cable connection.....	52
In the case of USB Flash Drive output .....	53
■ <b>Manual uninstallation</b> .....	<b>55</b>
<b>For Windows 8/Windows 8.1</b> .....	<b>56</b>
■ <b>Manual installation</b> .....	<b>56</b>
In the case of USB cable connection.....	56
In the case of USB Flash Drive output .....	57



■ Manual uninstallation.....	59
For Windows 10 .....	60
■ Manual installation .....	60
In the case of USB cable connection.....	60
In the case of USB Flash Drive output .....	61
■ Manual uninstallation.....	63

## Appendix

---

Troubleshooting Tips .....	65
Error Message on PC's Display .....	65
Operation Problems.....	66



# Installing the Printer Driver

The method of installing the Printer Driver using the installer is described here.

■ <b>USB Connection</b> .....	<b>9</b>
Installing the Printer Driver .....	9
■ <b>USB Flash Drive Output</b> .....	<b>14</b>
About USB Flash Drives .....	14
Installing the USB flash-via-Printer Driver .....	14
Create a Folder .....	20
Printing a test page .....	21

# ■ USB Connection

## Installing the Printer Driver

This section describes how to install the Printer Driver for Windows versions supporting Plug&Play installation when your computer and the RISO printer are connected via USB cable.

(Regarding the procedure for manual installation, see [page 47](#).)

### IMPORTANT!

- You are required to have the Administrator rights to install the printer driver program on your computer.
- This Printer Driver does not support server OS or printer sharing.
- Use a commercially available USB cable (2 m (6.6 feet) or less).

To update the Printer Driver, change cable connections, or reinstall a Printer Driver of the same series, deletion of the driver package is required. Uninstall the installed Printer Driver manually before a new installation. "Manual uninstallation" ([Page 47](#))

**0**

**Make sure that the printer is turned off and that the computer and printer are not connected with a USB cable.**

### IMPORTANT!

At some point during the installation procedure (step 6/7) you will need to connect the USB cable and turn the printer on.

**1**

**Insert the [RISO Printer Driver] CD-ROM into your computer's CD-ROM drive.**

The installer is started. If the installer does not start up, double-click on the [Setup(.exe)] file in the folder below.

#### **For Windows (32-bit):**

(CD-ROM):[Windows 32-bit] folder

#### **For Windows (64-bit):**

(CD-ROM):[Windows 64-bit] folder

**NOTE** If the [User Account Control] dialog appears, click [Yes] or [Allow] (for Windows Vista).

**2**

Select your language from the drop-down list, then click [OK].

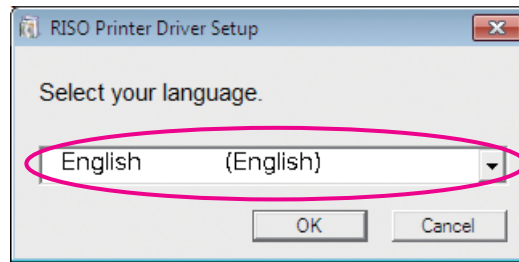

**3**

Click [Next].

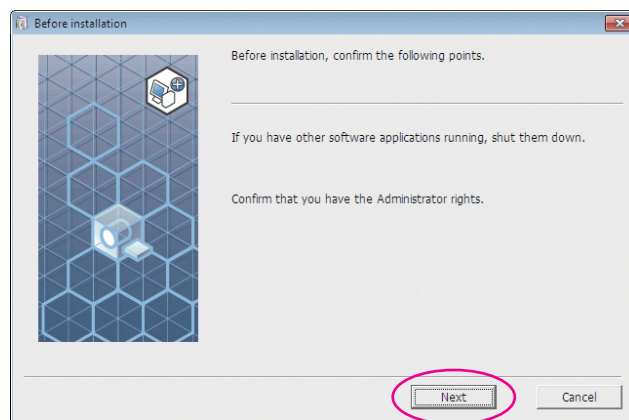

**4**

Select [Connect via a USB cable] and click [Next].

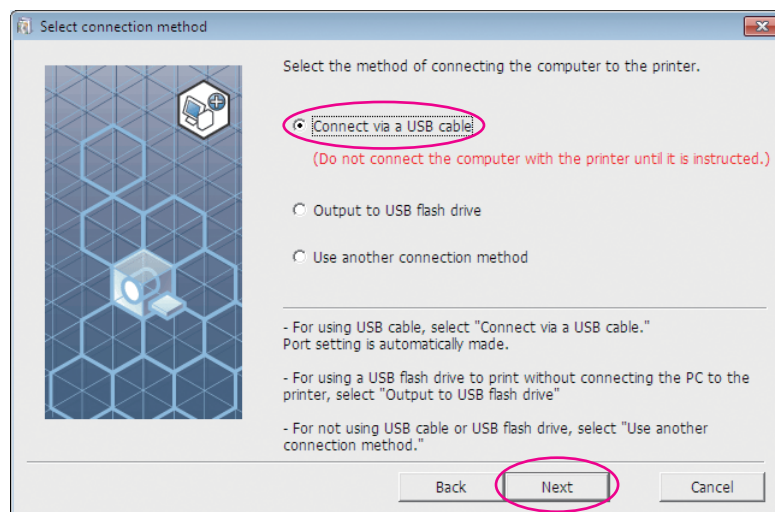

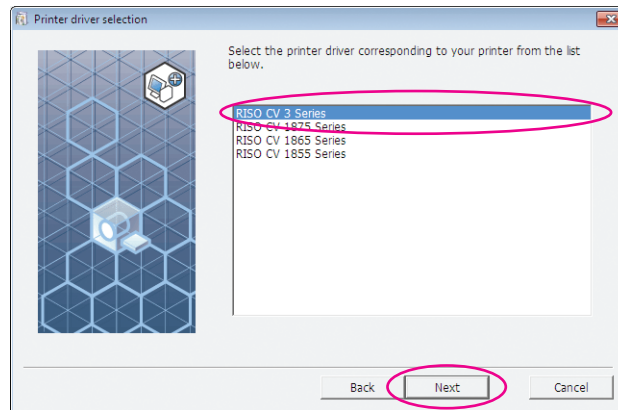
**5****Select the printer name you just connected and click [Next].****6****Click [Install].**

When you place a checkmark in the [Install also the User's Guide (PDF)] checkbox, the User's Guide (PDF) will also be installed.

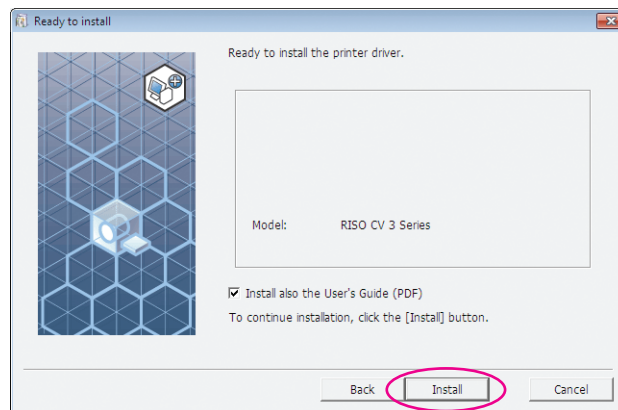

**NOTE** If a [Windows Security] dialog appears, continue with installation.  
The [USB port setting] dialog box appears.

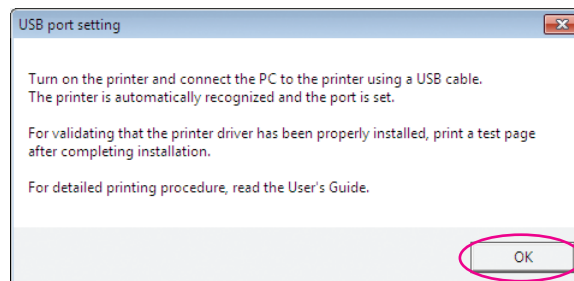
**7****Click [OK].****8****Turn on the RISO printer.**

**9**

**Connect the computer to the RISO printer with a USB cable (2 m (6.6 feet) or less).**

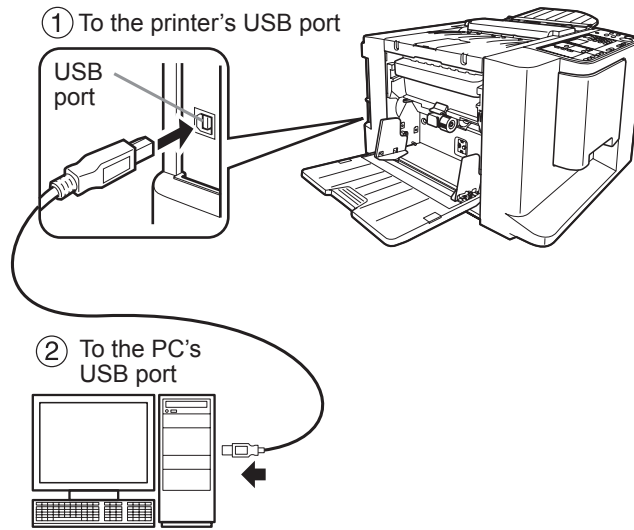

**10**

**Open the printer folder and check that the connected printer has been added.**

**For Windows Vista:**

Click on the [Start] icon-[Control Panel]-[Hardware and Sound]-[Printers] and open the [Printers] folder.

**For Windows 7:**

Click on the [Start] icon-[Control Panel]-[Hardware and Sound]-[Devices and Printers] and open the [Devices and Printers] folder.

**For Windows 8/Windows 8.1:**

Open the "Apps" screen and click [Control Panel]-[Hardware and Sound]-[Devices and Printers] and open the [Devices and Printers] folder.

**For Windows 10:**

Right-click on the [Start] icon and click [Control Panel]-[Hardware and Sound]-[Devices and Printers] and open the [Devices and Printers] folder.

**11**

**Click [Show "ReadMe" text].**

The ReadMe file is opened. Be sure to read all the instructions and notes in it.

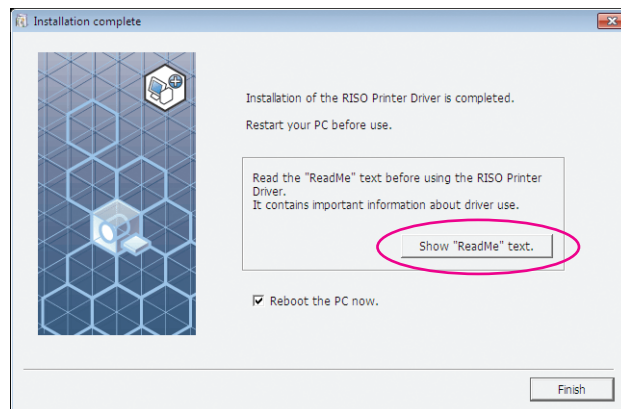

**12****Click [Finish].**

Be sure to restart the computer before using the Printer Driver. If you have checked [Reboot the PC now.], the computer will be shut down and restarted when you click [Finish].

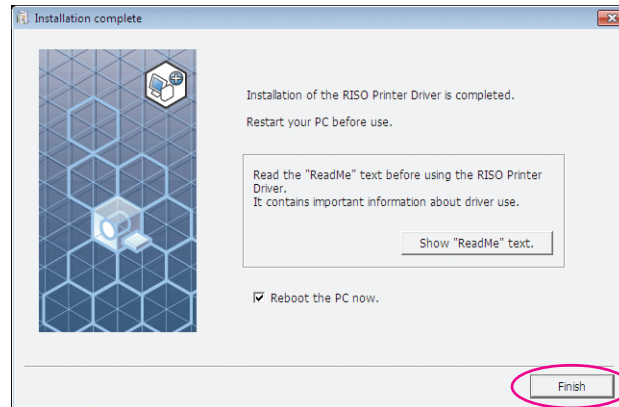
**13****Open the printer folder.****For Windows Vista:**

Click on the [Start] icon-[Control Panel]-[Hardware and Sound]-[Printers] and open the [Printers] folder.

**For Windows 7:**

Click on the [Start] icon-[Control Panel]-[Hardware and Sound]-[Devices and Printers] and open the [Devices and Printers] folder.

**For Windows 8/Windows 8.1:**

Open the “Apps” screen and click [Control Panel]-[Hardware and Sound]-[Devices and Printers] and open the [Devices and Printers] folder.

**For Windows 10:**

Right-click on the [Start] icon and click [Control Panel]-[Hardware and Sound]-[Devices and Printers] and open the [Devices and Printers] folder.

**14****Open the properties of the printer for which the Printer Driver has been installed.**

Right-click on the icon of the printer, and select [Printer Properties] in the displayed menu.

**15****Click [Print Test Page].****16****When a message appears, wait for a few seconds and click [Close].****17****Then remove the [RISO Printer Driver] CD-ROM from the CD-ROM drive of your computer.****IMPORTANT!**

Keep the removed CD-ROM at hand.

Printer driver installation is now complete.

---

# ■ USB Flash Drive Output

## (Not available for CV1200 series)

### About USB Flash Drives

---

- Use a USB Flash Drive compatible with Mass Storage Class. Depending on the type of USB Flash Drive, the Printer Driver may not work properly.
- When connecting or removing a USB Flash Drive, insert it or pull it out slowly using the correct method.
- If the USB Flash Drive is damaged by natural disaster, etc., the data saved on the USB Flash Drive cannot be guaranteed. It is recommended to back up important data with the computer with which the data was created.

### Installing the USB flash-via-Printer Driver

---

This section describes how to install the USB flash-via-Printer Driver when using a USB Flash Drive to print.

(Regarding the procedure for manual installation, see [page 47](#).)

#### **IMPORTANT!**

- You are required to have the Administrator rights to install the Printer Driver program on your computer.
- This Printer Driver does not support server OS or printer sharing.

#### **1**

#### **Insert the [RISO Printer Driver] CD-ROM into your computer's CD-ROM drive.**

The installer is started. If the installer does not start up, double-click on the [Setup(.exe)] file in the folder below.

#### **For Windows (32-bit):**

(CD-ROM):[Windows 32-bit] folder

#### **For Windows (64-bit):**

(CD-ROM):[Windows 64-bit] folder

**NOTE** If the [User Account Control] dialog appears, click [Yes] or [Allow] (for Windows Vista).

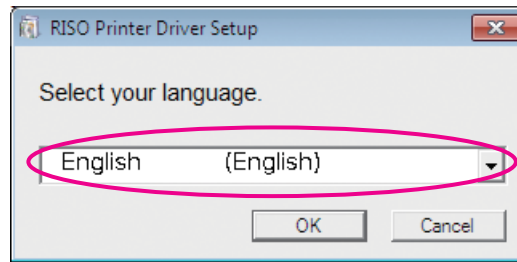
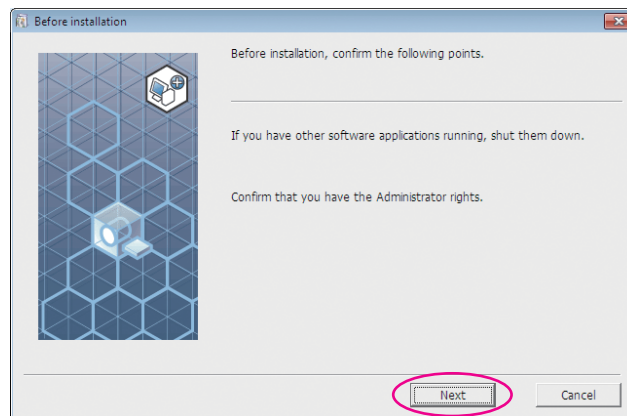
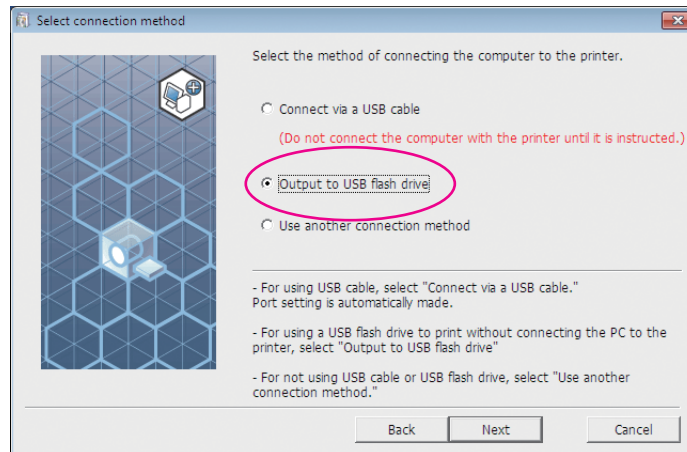

**2****Select your language from the drop-down list, then click [OK].****3****Click [Next].****4****Select [Output to USB flash drive].**

**5**

**Click [Next].**

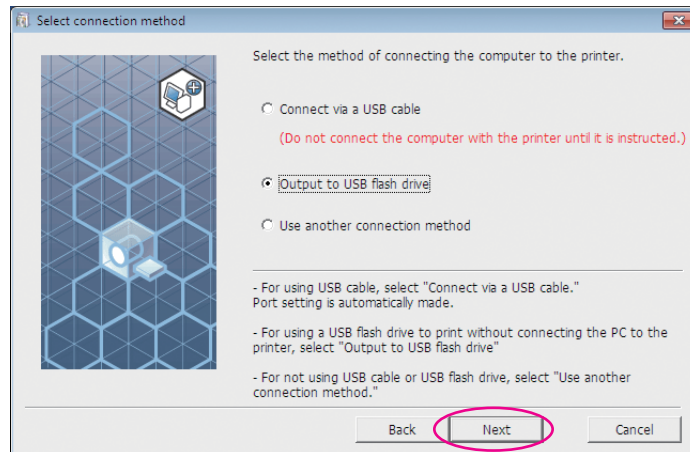

**6**

**Select the printer name to use.**

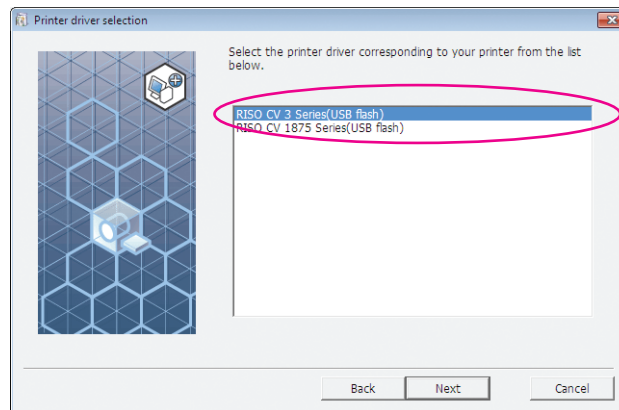

**7**

**Click [Next].**

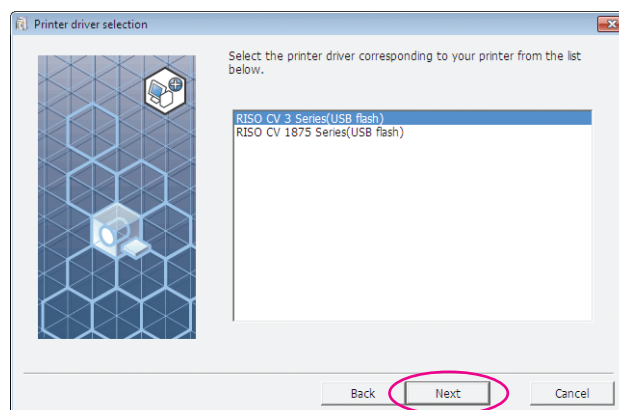

**NOTE** When the selected Printer Driver is already installed, a “Procedure of installation” dialog box appears. Click [Next].

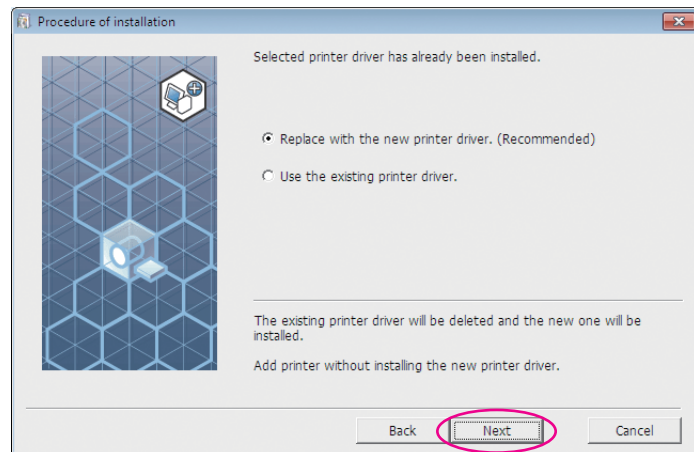
**8**

**Click [Next].**

You can also change the printer name.

**NOTE** When changing the printer's name, we recommend leaving (USB flash) in the name.

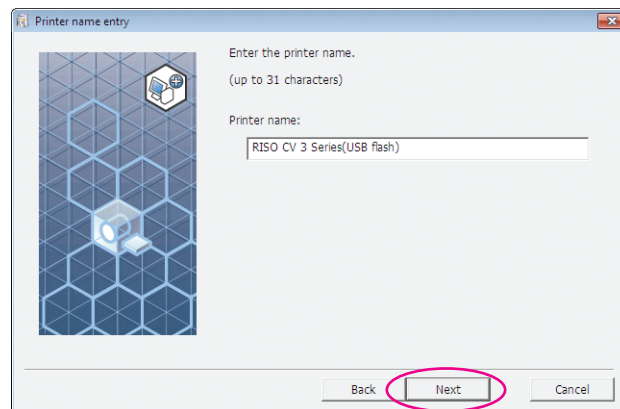

9

**Click [Install].**

When you place a checkmark in the [Install also the User's Guide (PDF)] checkbox, the User's Guide (PDF) will also be installed.

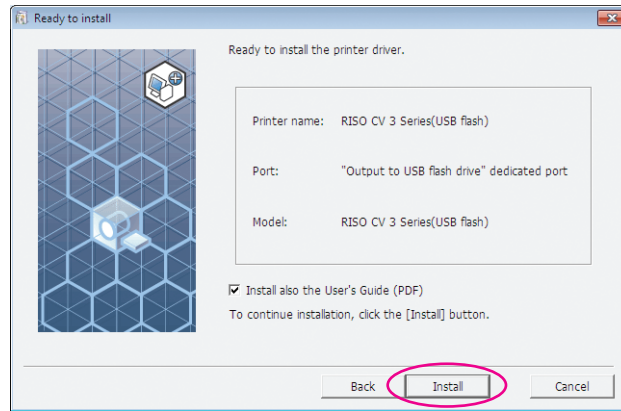

**NOTE** When the [Windows Security] dialog appears, continue with installation.

10

**When the following message appears, click [OK].**

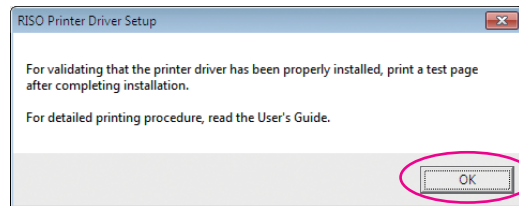

**NOTE** Please refer to "Create a Folder" and "Printing a test page" for output of test page to a USB Flash Drive.

11

**Click [Show "ReadMe" text].**

The ReadMe file is opened. Be sure to read all the instructions and notes in it.

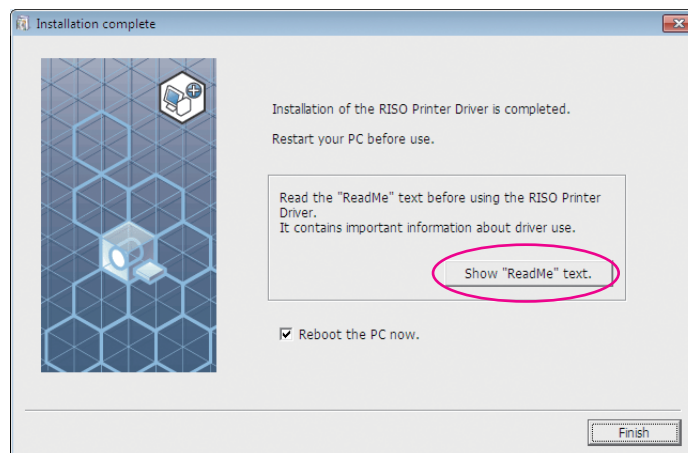

**12****Click [Finish].**

Be sure to restart the computer before using the Printer Driver. If you have checked [Reboot the PC now.], the computer will be shut down and restarted when you click [Finish].

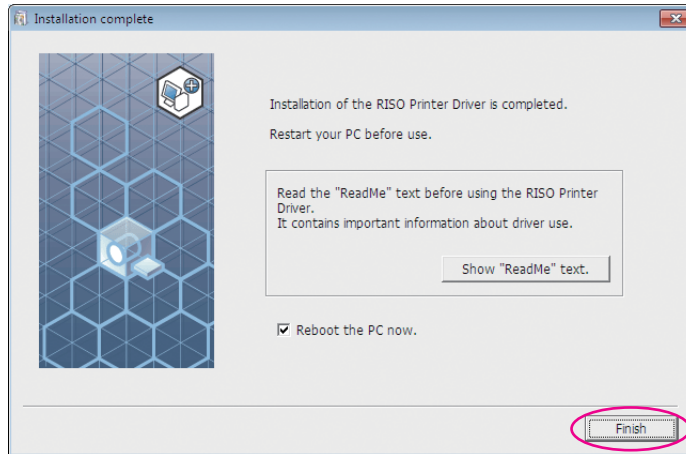
**13**

**Then remove the [RISO Printer Driver] CD-ROM from the CD-ROM drive of your computer.**

**IMPORTANT!**

**Keep the removed CD-ROM at hand.**

Printer driver installation is now complete.  
Create a dedicated folder on the USB Flash Drive. ([Page 20](#))

## Create a Folder

The procedure of creating a dedicated folder on the USB Flash Drive is described here.

### IMPORTANT!

When printing with a USB Flash Drive, be sure to create a dedicated folder on the USB Flash Drive. Printing is disabled from the USB Flash Drive for which a dedicated folder has not been created.

**NOTE** Instead of the following procedure, you can create a dedicated folder by connecting the USB Flash Drive to the printer.

**1**

**Connect the USB Flash Drive to the computer.**

**2**

**Display the [Print] dialog box.**

Open the original data to print on your computer, and select [Print] from the [File] menu.

**3**

**Select the printer for which the Printer Driver has been installed.**

Be sure to select the USB flash-via-Printer Driver.

**4**

**Click [Properties].**

**5**

**Click [OK] in the [Properties] dialog box.**

**6**

**When a message appears, click [Yes].**

The dedicated folder is created in the USB Flash Drive.

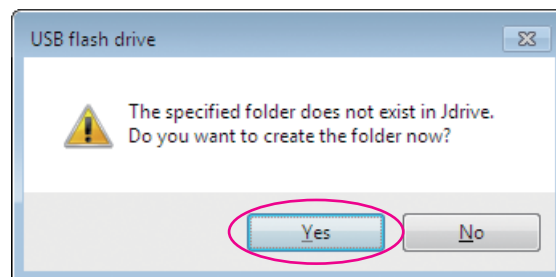

Next, print a test page.

## Printing a test page

This section describes the procedures for printing a test page using the USB flash-via-Printer Driver.

### IMPORTANT!

Use the USB Flash Drive on which a dedicated folder (Page 20) has been created in advance.

**1**

### Open the printer folder.

#### For Windows Vista:

Click on the [Start] icon-[Control Panel]-[Hardware and Sound]-[Printers] and open the [Printers] folder.

#### For Windows 7:

Click on the [Start] icon-[Control Panel]-[Hardware and Sound]-[Devices and Printers] and open the [Devices and Printers] folder.

#### For Windows 8/Windows 8.1:

Open the “Apps” screen and click [Control Panel]-[Hardware and Sound]-[Devices and Printers] and open the [Devices and Printers] folder.

#### For Windows 10:

Right-click on the [Start] icon and click [Control Panel]-[Hardware and Sound]-[Devices and Printers] and open the [Devices and Printers] folder.

**2**

### Open the properties of the printer for which the USB flash-via-Printer Driver has been installed.

Right-click on the icon of the printer (USB flash), and select [Printer Properties] or [Properties] (for Windows Vista) in the displayed menu.

**3**

### Click [Print Test Page].

**4**

### When a message appears, wait for a few seconds and click [Close].

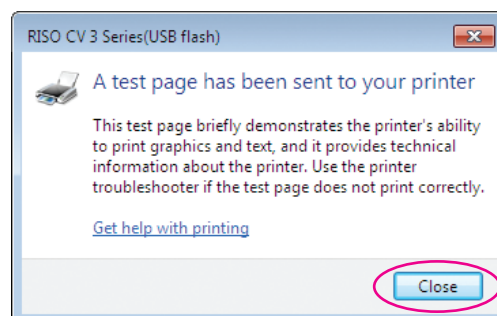

The data of the test page is saved on the USB Flash Drive.



**5**

**Make sure the printer is ON.**

Check the Control Panel.

- NOTE** • When the power is OFF, both the Display and the  key are off. Turn the power ON.
- If the  key is lit, the printer is in the Energy Saving mode. Press the  key to cancel the Energy Saving mode.

**6**

**Check the printer paper.**

Make sure A4 paper is loaded.

**7**

**Connect the USB Flash Drive that contains the original data to print to the USB slot.**

When the printer is receiving data, the  indicator blinks.

When data reception is finished, the printer automatically starts printing.

After master-making, the data in the USB Flash Drive is automatically deleted.

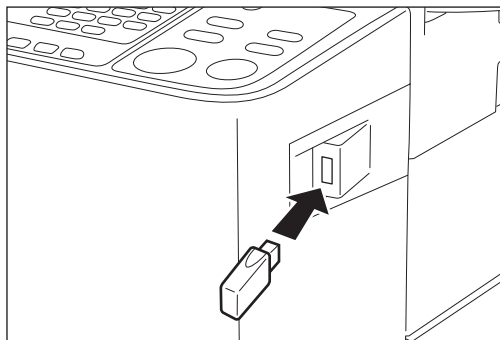

**IMPORTANT!**

**While data is being processed, do not remove the USB Flash Drive. This will cause data to disappear and the USB Flash Drive to malfunction.**





# Working with the Printer Driver

■ Changing the Printer Driver	
Configuration .....	24
■ Sending and Printing Data .....	27
■ Setting the Print Conditions .....	31
[Basic] Tab .....	31
[Layout] Tab .....	34
[Image] Tab .....	36
[Advanced] Tab .....	39
[Option] Tab .....	41
[About] Tab .....	42

# ■ Changing the Printer Driver Configuration

For customized use, register optional devices and frequently-used custom paper sizes. If you do not change the Printer Driver configuration, you will not be able to select the corresponding option when specifying the print conditions of your print job.

**NOTE** The screen shots of the Printer Driver shown here are taken from Printer Driver. (not USB flash-via-Printer Driver).

## 1

### Open the printer folder.

#### For Windows Vista:

Click on the [Start] icon-[Control Panel]-[Hardware and Sound]-[Printers] and open the [Printers] folder.

#### For Windows 7:

Click on the [Start] icon-[Control Panel]-[Hardware and Sound]-[Devices and Printers] and open the [Devices and Printers] folder.

#### For Windows 8/Windows 8.1:

Open the “Apps” screen and click [Control Panel]-[Hardware and Sound]-[Devices and Printers] and open the [Devices and Printers] folder.

#### For Windows 10:

Right-click on the [Start] icon and click [Control Panel]-[Hardware and Sound]-[Devices and Printers] and open the [Devices and Printers] folder.

## 2

### Open the [Environment] tab of the [Properties] dialog box.

Right-click the corresponding RISO printer icon in the printer folder and select [Printer Properties] or [Properties] (for Windows Vista) in the displayed menu. Then click [Environment] in the [Properties] dialog box.

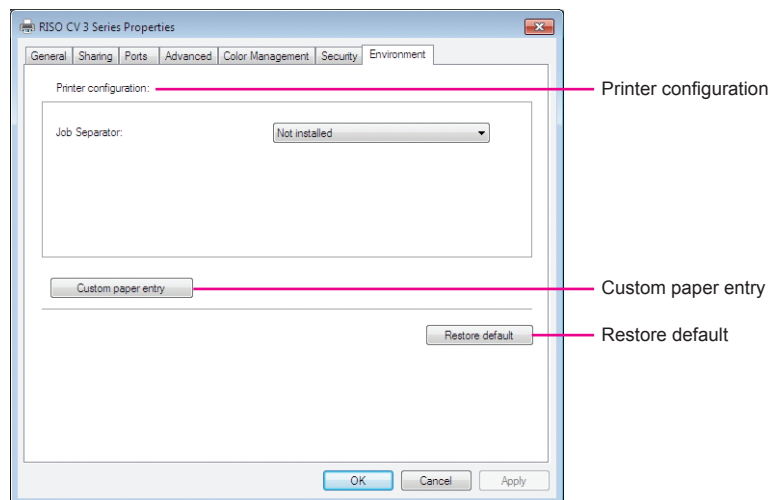

**3**

**Register the options if needed.**

● **Registering optional devices**

**Job Separator\***

Select [Installed] if your RISO printer is equipped with the Job Separator.

\* Not displayed in the CV1200 Series.

● **Registering Custom Paper Size as Standard**

You can register custom paper sizes as standard in the [Custom paper entry] dialog box, which can be opened by clicking [Custom paper entry] in the [Environment] tab of the [Properties] dialog box. The custom paper sizes can be named and displayed in the [Original size] of the [Basic] tab.

1) Click [Custom paper entry] to display the [Custom paper entry] dialog box.

2) Enter the width, length and name and click [Add].

The registered name appears in the dialog box.

- NOTE**
- The length of the name can be up to 30 characters.
  - You can change the unit of length from “mm” to “inch”.

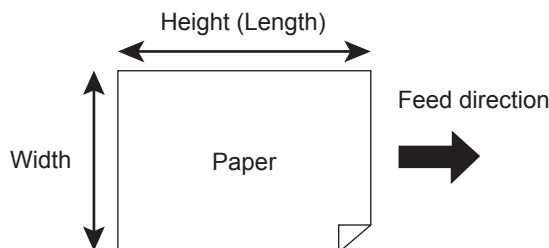
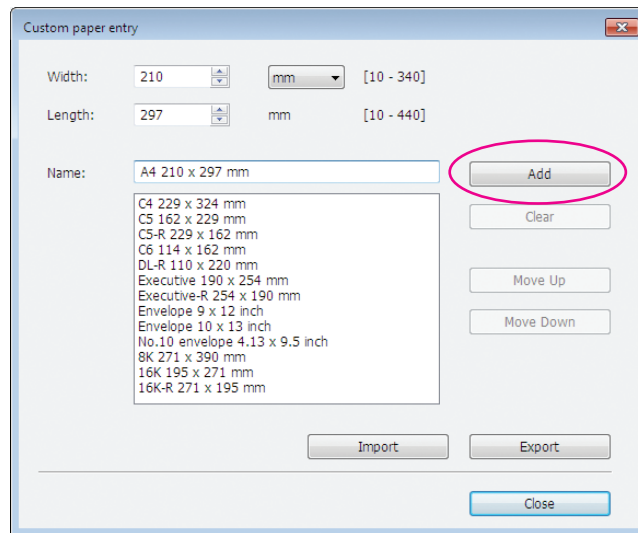

**3) Click [Close] in the [Custom paper entry] dialog box.**

**IMPORTANT!**

Even if you use paper registered in the Custom paper entry, it may not pass through the printer depending on such factors as the paper quality, ambient conditions and storage conditions.

- NOTE** • You can save custom paper size information as a Custom paper entry information file (.udp extension) by clicking [Export]. If you want to register the custom paper size from a Custom Paper Entry information file, click [Import] to select the file.
- When registering paper using horizontal orientation, enter the size of the long edge in [Width] and enter the size of the short edge in [Length].
  - Entry of the name and dimensions will help you when you select the paper size. The length of the name can be up to 30 characters.
  - The registrable paper size varies with the printer you use. For details, see the user's guide of your printer.
  - When deleting a custom paper size, select the corresponding name from the list and click [Clear].

● **Changing the settings back to their defaults**

Change the settings under the [Environment] tab back to normal.

**4**

**Complete the setting.**

Click [OK] on the [Environment] tab.

# ■ Sending and Printing Data

Follow the procedures given below to print out document data directly on your RISO printer.

If the corresponding RISO Printer Driver has not been installed on your computer yet, install it first, referring to the section “Installing the Printer Driver” on [page 8](#).

## **IMPORTANT!**

- The maximum print area is different depending on the model of RISO printer. If you want to know the maximum print area of your document, consult the user’s guide of your RISO printer.
- For other limitations, also read the user’s guide of your RISO printer.

**1**

### **Turn on your RISO printer and load paper.**

Load the proper paper to be printed.

**2**

### **Specify the print job in the [Print] dialog box.**

Turn on your computer and start Windows.

Open the document file to be printed, select [Print] in the [File] menu to open the [Print] dialog box.

**3**

### **Select a Printer Driver.**

Select a Printer Driver that supports your printer from the [Printer Name] list.

To print from a USB Flash Drive, select [Printer Name (USB flash)] and connect the USB Flash Drive to your computer. (Not available for CV1200 series)

# 4

## Check print conditions.

- Specify the number of copies to be printed within the following range : 1 to 9,999.
- Never fail to deselect the [Collate] box. If it is selected, the master-making operation will be repeated for every copy.

The displayed items in the [Print] dialog box vary depending on the application software.

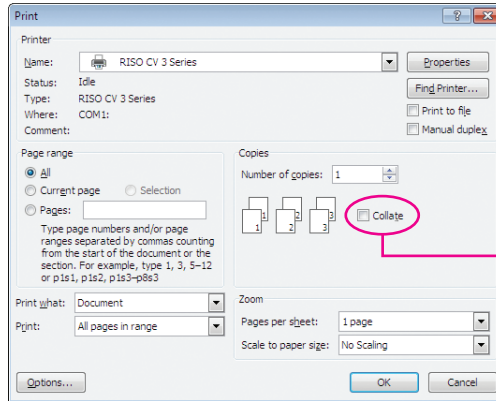

Remove the check mark for [Collate].

### IMPORTANT!

If you want to print a file consisting of several pages, and the file include different paper sizes or page directions, printing may fail when you choose [All] for the paper range. Specify page numbers to print for those of the same page size or direction.

### To set additional print conditions for the current print job

Open the [Properties] dialog box by clicking [Properties] in the [Print] dialog box.

### IMPORTANT!

Some printer settings are not available depending on access privileges.

[Basic] Tab (refer to [page 31](#) for detailed settings)

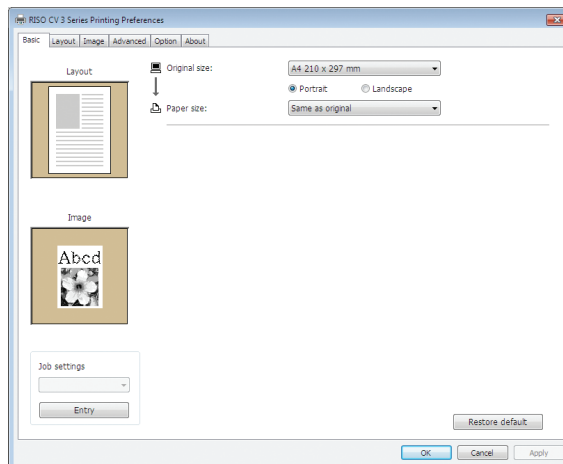

### IMPORTANT!

Paper size and page orientation settings for this tab should be identical to those in the application software to be used.

**[Layout] Tab** (refer to [page 34](#) for detailed settings)

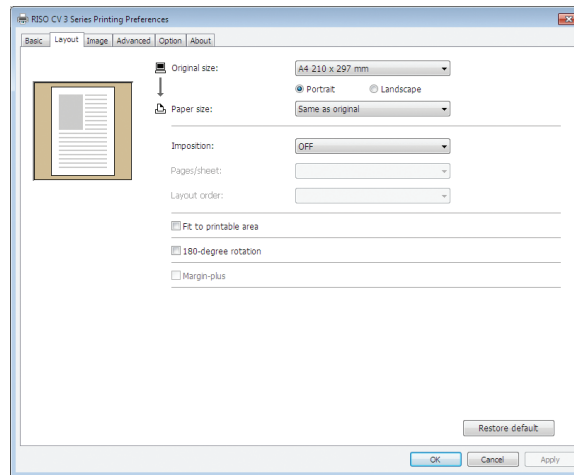

**[Image] Tab** (refer to [page 36](#) for detailed settings)

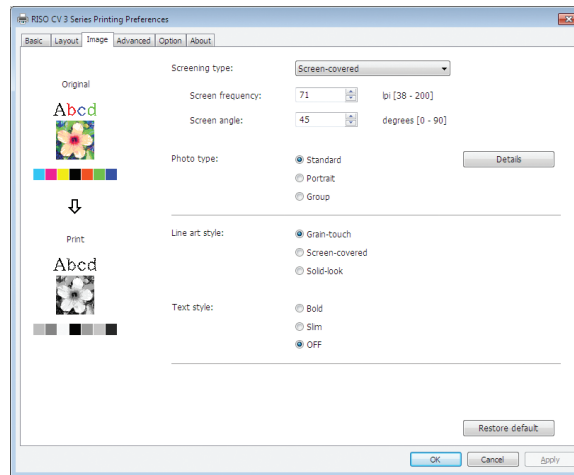

**[Advanced] Tab** (refer to [page 39](#) for detailed settings)

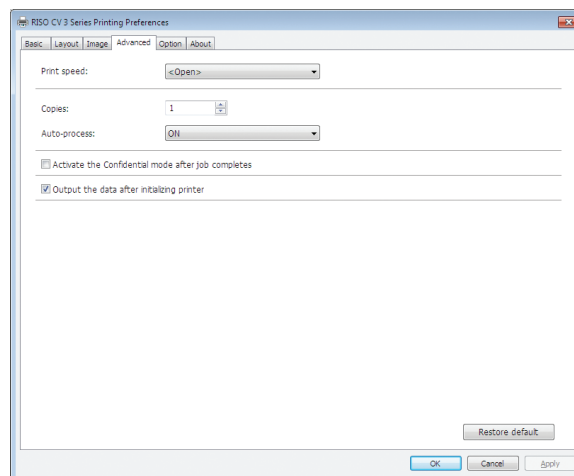

**[Option] Tab** (refer to [page 41](#) for detailed settings)

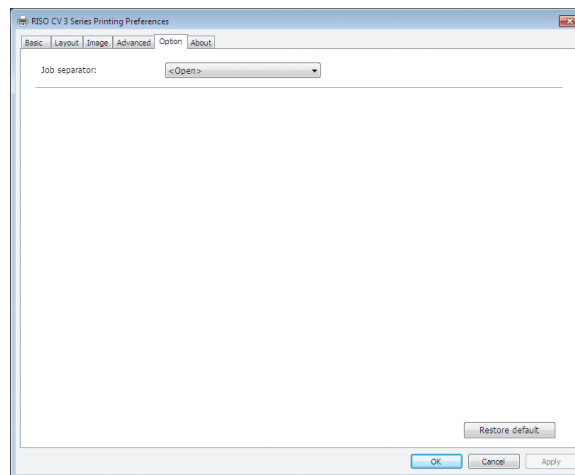

**5**

**Start printing.**

Click [OK] in the [Print] dialog box.

The selected document file data is then transmitted to your RISO printer and printed out there as specified in the previous step.

When using a USB Flash Drive, data is output to the USB Flash Drive. Disconnect the USB Flash Drive from the computer, connect it to the printer and print the data. After master-making, the data in the USB Flash Drive is automatically deleted.

For printing procedures, see the User's Guide of your RISO printer.



# ■ Setting the Print Conditions

You can set various print conditions with the tabs in the [Properties] dialog box.

To open this dialog box, click [Properties] in the [Print] dialog box.

## [Basic] Tab

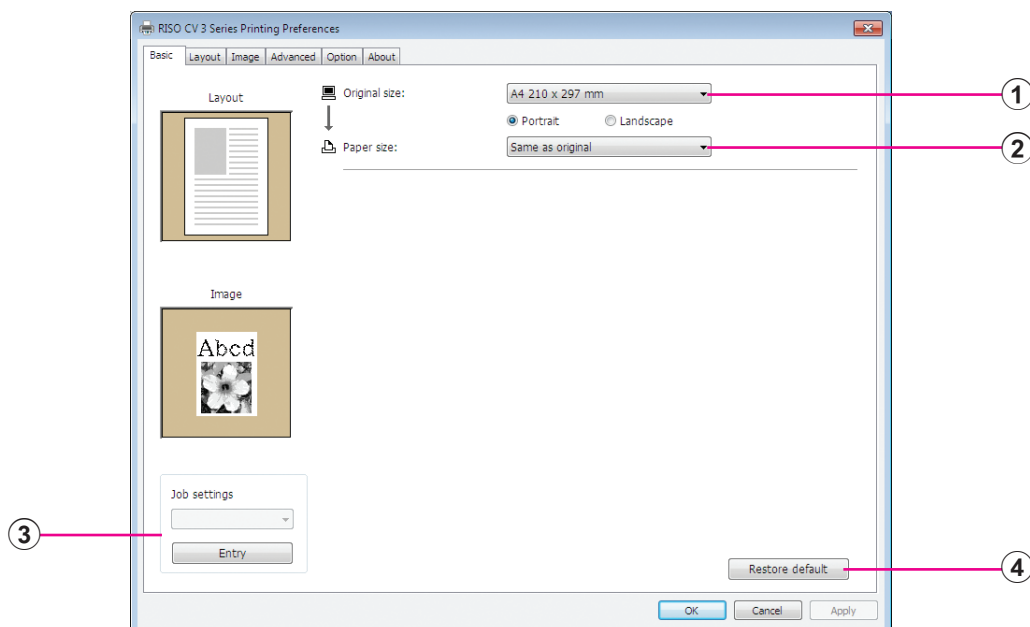

### Settings

① Original size

③ Job settings

② Paper size

④ Restore default

### ① Original size

Setting the original size and paper direction.

#### **IMPORTANT!**

Be sure to specify the same page direction which was set in the application software used when creating the document data.

When paper is fed with the long edge first, select the paper size whose name contains the word “-R”.

When using any other custom-size paper than the displayed one, select [Custom] and enter its width and length in the boxes.

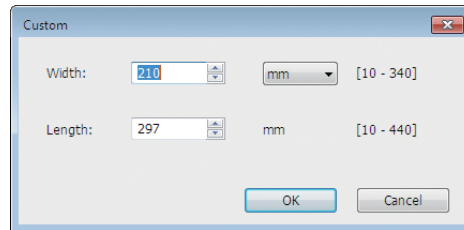
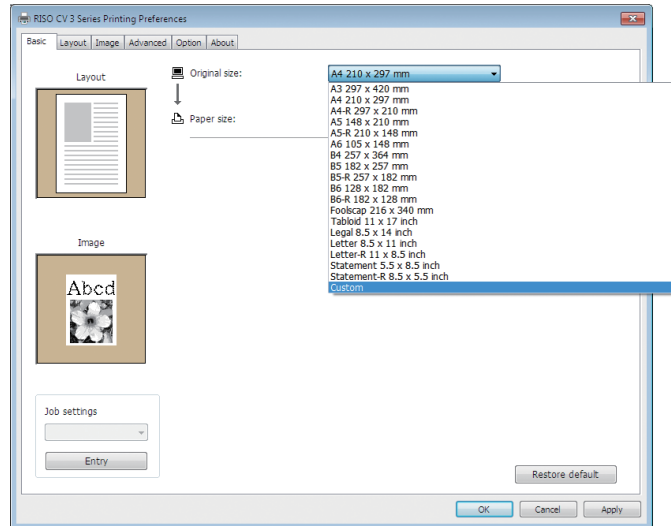

- NOTE**
- You can select custom-size paper from the drop-down list by registering it beforehand. (Page 25)
  - The range of paper sizes that can be entered in the [Custom] dialog box depends on your RISO printer. For details, see the User's Guide of your RISO printer.
  - You can select the unit of size from [mm] and [inch].

**[Portrait] [Landscape]**

This option is used for matching the page direction with the feed direction. Specify the page direction.

**IMPORTANT!**

Be sure to specify the same page direction which was set in the application software used when creating the document data.

**② Paper size**

Select the paper size for printing.

To turn off scaling, select [Same as original].

If you select a paper size that is different from the original text, the image will be scaled to fit the selected paper size.

### ③ Job settings

You can name and register the printer settings you often use.  
The registered printer settings can be called up.

#### **IMPORTANT!**

To register/delete the printer settings, you are required to have Administrator rights when logged in to Windows.

- 1) Make the printer settings in the [Properties] dialog box.
- 2) Clicking [Entry] displays the [Entry] dialog box.
- 3) The name registered appears in the [Status list:] by entering the name in the column under [Name:] and clicking [Entry].

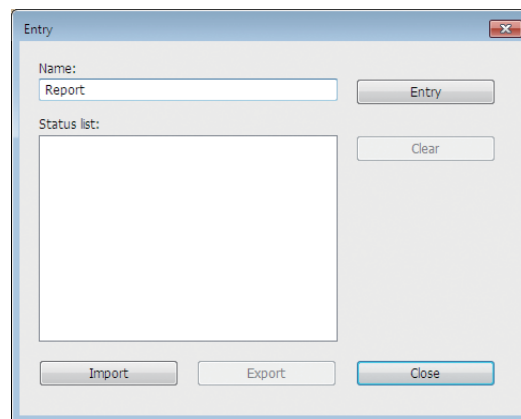

- 4) Click [Close].

- NOTE** • The registered printer settings can be saved as a printer settings entry file by clicking [Export].  
To register printer settings from a printer settings entry file, click [Import] and specify the file.
- To delete the registered printer settings, select the name to be deleted and click [Clear].

### ④ Restore default

Clicking [Restore default] changes the settings in the [Properties] dialog box back to their defaults.

- NOTE** This is also displayed on the [Layout], [Image], [Advanced] and [Option] tabs.

# [Layout] Tab

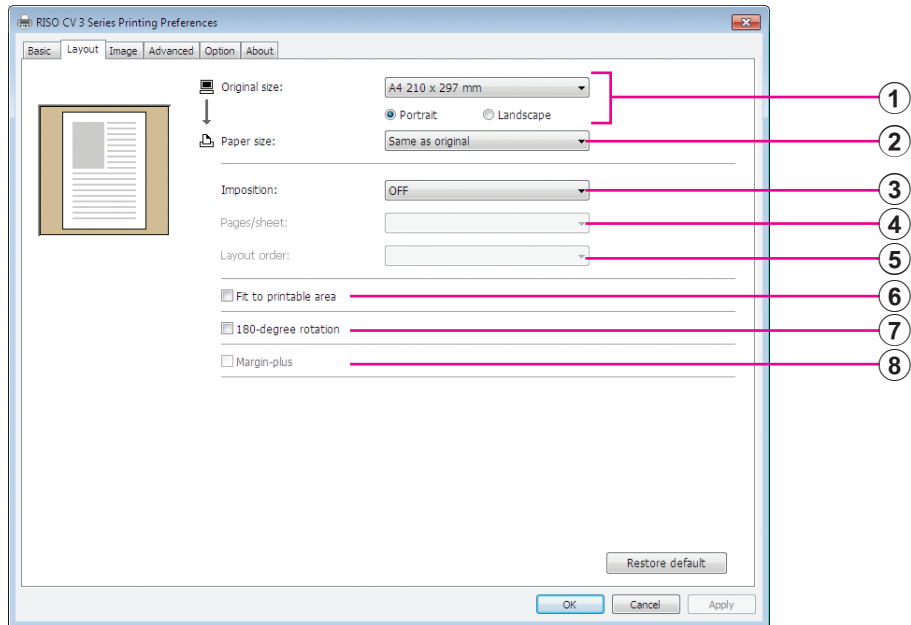

## Settings

- ① Original size\*
- ② Paper size\*
- ③ Imposition
- ④ Pages/sheet
- ⑤ Layout order
- ⑥ Fit to printable area
- ⑦ 180-degree rotation
- ⑧ Margin-plus

\* The settings are made depending on the settings in the [Basic] tab. (Page 31)

### ① Original size

[Basic] Tab - [Original size] (Page 31)

### ② Paper size

[Basic] Tab - [Paper size] (Page 32)

### ③ Imposition

You can impose multiple originals on one page and print them.

**OFF** : Nomal printing (one original page per sheet).

**Multi-up** : The same original is imposed multiple times on one sheet of paper.

**Page layout** : Different original pages are imposed on one sheet of paper.

**Multi-up**

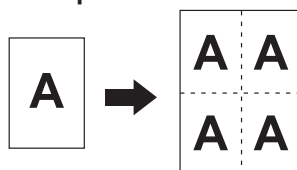

**Page layout**

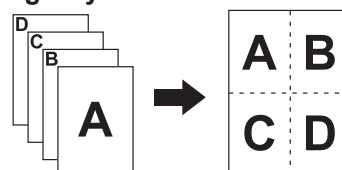

**④ Pages/sheet**

When [Multi-up] or [Page layout] is selected, select the number of pages.

**2 pages** : Imposes 2 original pages on a sheet.

**4 pages** : Imposes 4 original pages on a sheet.

**⑤ Layout order**

When [Page layout] is selected, select the imposition order and opening direction.

● **Page layout (2 pages)**

**Left to right (Top to bottom)** : Original pages are imposed from left to right or from top to bottom.

**Right to left (Bottom to top)** : Original pages are imposed from right to left or from bottom to top.

● **Page layout (4 pages)**

**Left top to right** : Original pages are imposed from left top to right.

**Left top to bottom** : Original pages are imposed from left top to bottom.

**Right top to left** : Original pages are imposed from right top to left.

**Right top to bottom** : Original pages are imposed from right top to bottom.

**⑥ Fit to printable area**

If the original page does not have large enough margins for printing, it is normally printed as it is without page size reduction.

If the original page has a smaller margin, the part that exceeds the effective print range is not printed out.

In such cases, if you place a checkmark here, the whole page is printed out by adding a margin (changing the reduction rate) and preventing the edge of the paper from being removed.

**NOTE** This option is not available when [Margin-plus] is selected.

**⑦ 180-degree rotation**

You can rotate print images by 180 degrees by activating this option.

**⑧ Margin-plus**

If you select this check box, printing will be done in a 95% scaling.

**NOTE** If [Fit to printable area] is not selected, this option is not available.

# [Image] Tab

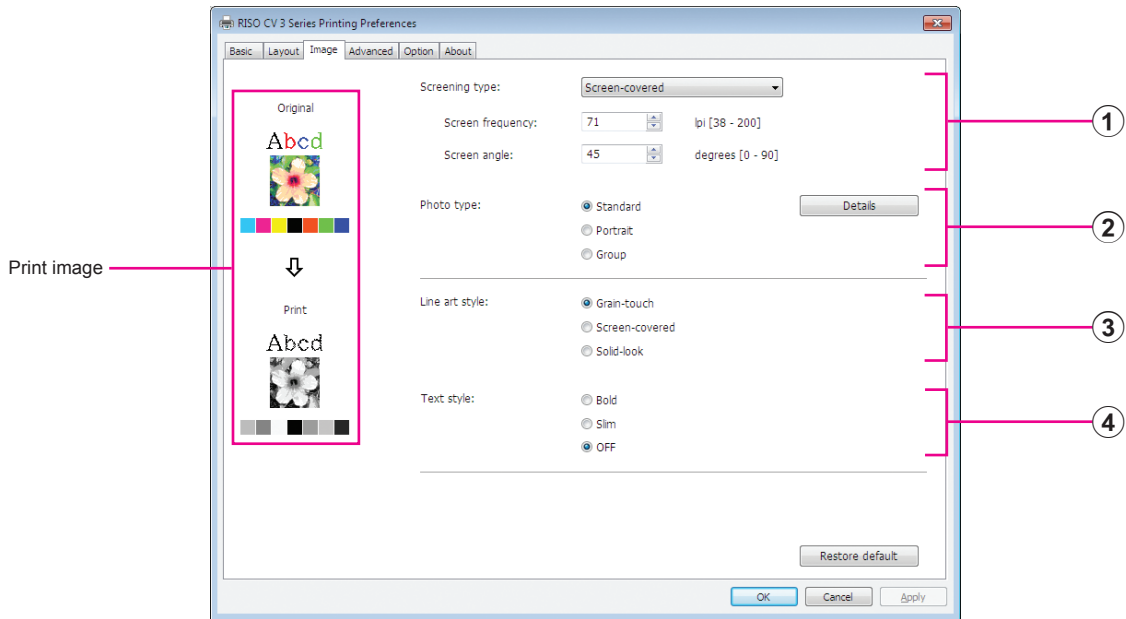

## Settings

### ① Screening type

- Grain-touch
- Screen-covered
- Screen frequency
- Screen angle

### ② Photo type

- Standard
- Portrait
- Group

### ③ Line art style

- Grain-touch
- Screen-covered
- Solid-look

### ④ Text style

- Bold
- Slim
- OFF

### ① Screening type

You can select either of the following two styles to print out photo images in your document data. The print result of the selected style of photo images is seen on the left side of the screen.

#### Grain-touch:

Various tones of photo images are reproduced by changing the number of dots in an area according to original density. The printed-out photo images will have a grain-touch appearance.

#### Screen-covered:

Various tones of photo images are reproduced by changing the size of dots according to original density. The printed-out photo images will be covered with a dot screen.

Though the wide range of tone levels in original photo images can be kept in this style, their fineness will be lowered.

When you select [Screen-covered], you can set the screen-covered parameter.

## ② Photo type

### Screen frequency

You can select the frequency of dots per inch (25.4 mm). You can select the value from 38 to 200. The default value is 71.

### Screen angle

You can select the angle of dot direction so as to make adjustments against moire or other problems. You can select the value from 0 to 90. The default value is 45.

Select the type of photo and set image finishing.

### Standard

Clicking [Details] enables settings to be made for brightness and contrast. Clicking [Details] opens the [Photo adjustment] dialog box.

### Portrait

Use this setting for pictures of one or two individuals from the bust up. This type of image processing is particularly good for printing photos of faces.

### Group

This setting is for group photos that are over-exposed. This process is effective for restoring facial features that have become washed out by a flash.

**NOTE** When either [Portrait] or [Group] is selected, the “Photo adjustment” settings made for [Standard] are returned to their defaults.

### Photo adjustment

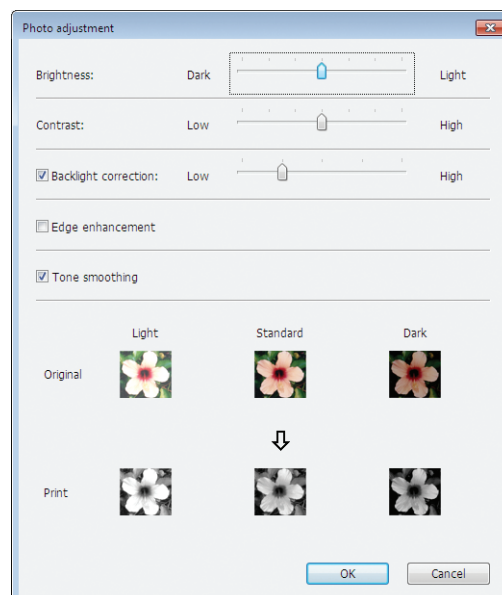

**Brightness** : The brightness of photo images can be adjusted by 7 levels.

**Contrast** : The contrast of the overall image can be adjusted by 7 levels.

**Backlight correction** : When a check mark is placed in the check box, back light correction is applied to the image to make it sharper.

### ③ Line art style

**Edge enhancement** : When a check mark is placed in the check box, edge enhancement is applied to the image to accent contours.

**Tone smoothing** : This setting is available when [Screen-covered] is selected for [Photo]. When a check mark is placed in the check box, the tonal expressions used in screen-covered processing are smooth.

Specifies the expression method of the line (text).

**Grain-touch** : This mode displays colors in a gradation. Bright colors are printed in light tones and dark colors are printed in deep tones.

**Screen-covered** : The text sections are displayed with halftone dots. This mode is unsuitable for small sized text.

**Solid-look** : This mode makes all text solid. You can use this mode to express the text clearly. The difference of each text color cannot be expressed.

### ④ Text style

You can adjust the thickness of text in this mode.

**Bold** : makes the text thicker when printed out (to prevent patchiness).

**Slim** : makes the text slimmer when printed out (to prevent crushed lines).

**OFF** : doesn't adjust the text volume.

**NOTE** Print image:

According to the settings for [Photo type], [Line art style] and [Text style], document data and print images will be displayed.

The actual document data and prints are different from the displayed images.



# [Advanced] Tab

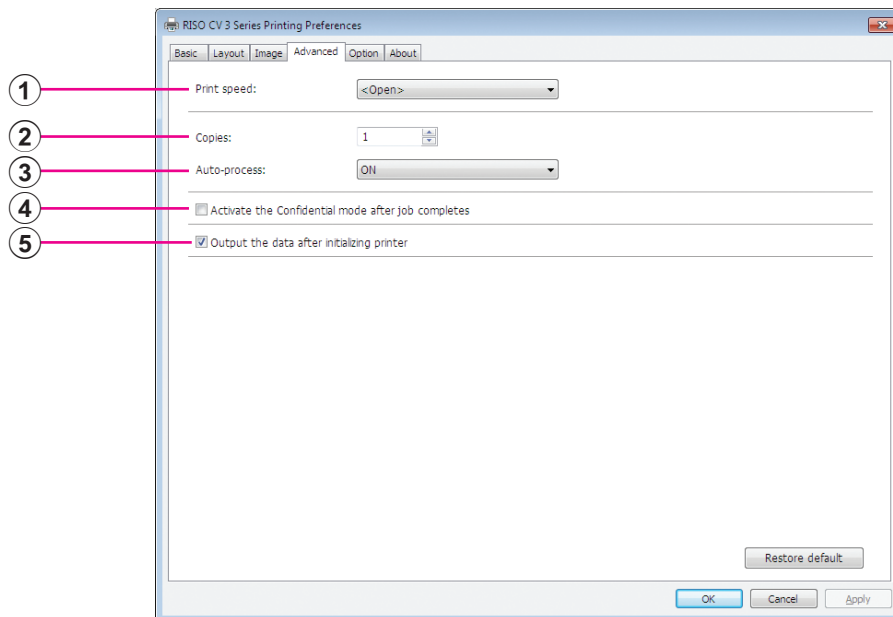

- Settings**
- ① **Print speed**
  - ② **Copies**
  - ③ **Auto-process**
  - ④ **Activate the Confidential mode after job completes**
  - ⑤ **Output the data after initializing printer**

## ① **Print speed**

Selects the print speed of the printer from 5 levels. If it remains [Open], the original is printed at the speed set on the printer side. With CV1200, the print speed is selected from 3 levels.

## ② **Copies**

You can use this field to specify the number of copies if no field is prepared for print quantity entry in your application software. When the number of copies can be specified in the [Print] dialog box of the application software, on the other hand, you can ignore this setting because it has no effect on printing operation.

**③ Auto-process**

You can specify how to process your print jobs on your RISO printer, i.e. complete them without interruption or interrupt them after a specified process step. By interrupting your print jobs, you can check print position and quality with test prints before continuing the print process or changing the print job flow according to your print requirements. The available process flows are as follows.

**ON:**

To complete print jobs without operator involvement on your RISO printer. No pause is made between master-making and printing processes until the end of print jobs.

**Pause before “Master-making”:**

To interrupt print jobs before each master-making process, thus allowing you to handle a stack of printed copies, especially useful for duplex printing. You can view the page image on the LCD of the printer to check what you are about to print.

**Pause before “Print”:**

To interrupt print jobs before each printing process, thus allowing you to check a sample print.

**OFF:**

To interrupt print jobs before each process step, i.e. both master-making and printing processes.

**④ Activate the Confidential mode after job completes**

You can prevent your confidential documents from being duplicated without your knowledge by selecting this check box. When this check box is selected, the remaining master is automatically replaced with a blank one after all specified print jobs are finished.

**⑤ Output the data after initializing printer**

Your RISO printer is initialized before receiving print data when this check box is selected. It is recommended to select this check box in most cases.

# [Option] Tab

■ This window appears only on CV3 series.

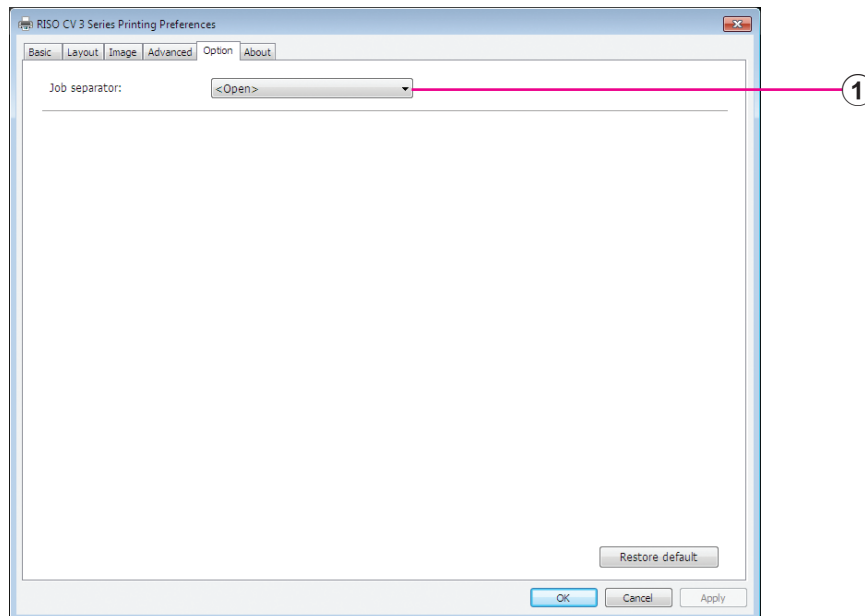

## Settings ① Job separator

■ The optional settings are displayed if your RISO printer is equipped with optional devices, which are selected in the [Environment] tab. (Page 24)

### ① Job separator

You can activate the job separator on your RISO printer and select the timing of separation tape insertion.

**<Open>** : Follow the present setting of your RISO printer.

**OFF** : No separation tape inserted.

**ON-Between jobs** : Insert separation tapes per job.

**ON-Between Pages** : Insert separation tapes per page.

**NOTE** Refer to the user's guide of the job separator for its functions and operations.

## [About] Tab

---

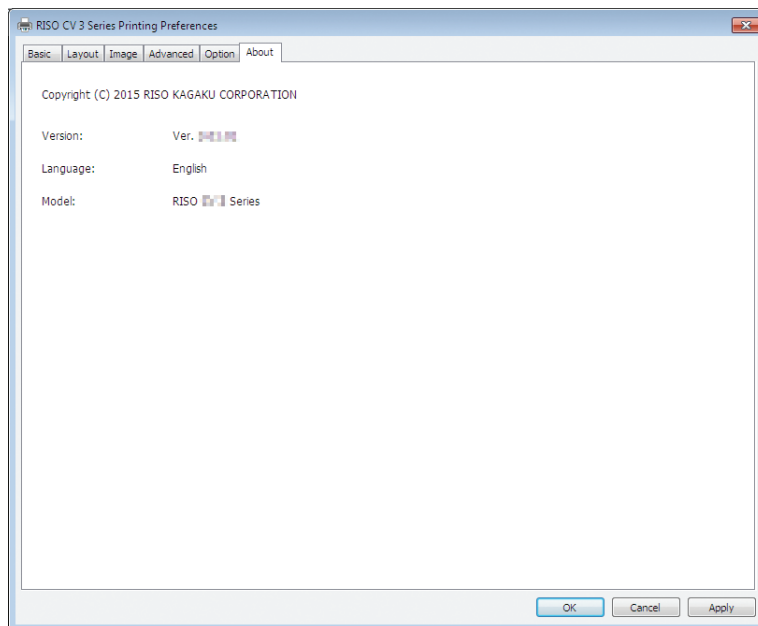

This tab shows the version number, language and model name of your Printer Driver.

In case you need to contact your service representative because of function errors, check this version number and so on beforehand.

# Uninstalling the Printer Driver

The procedure of uninstalling the Printer Driver using the uninstaller is described here.

In the case of uninstallation using the uninstaller, the driver package cannot be deleted. When the driver package needs to be deleted, such as for re-installation of the Printer Driver, uninstall the Printer Driver manually.

## ■ Uninstall the Printer Driver .....44

# ■ Uninstall the Printer Driver

The procedure of uninstalling the Printer Driver is described here.  
(Regarding the procedure of manual uninstallation, see [Page 47.](#))

**IMPORTANT!**

To uninstall the Printer Driver, it is necessary to log in to Windows with an account with the authority to change system settings (administrator, etc.).

**1**

**Start the Uninstaller.**

**For Windows Vista/Windows 7:**

Click [Start]-[All Programs]-[RISO]-[(Your printer model, XX Series)]-[Uninstaller] in this order.

**For Windows 8/Windows 8.1:**

Open the “Apps” screen and click [Uninstaller] in the [RISO (Your printer model, XX Series)] group.

**For Windows 10:**

Click [Start]-[All apps]-[RISO (Your printer model, XX Series)]-[Uninstaller] in this order.

**2**

**Select your language from the drop-down list, then click [OK].**

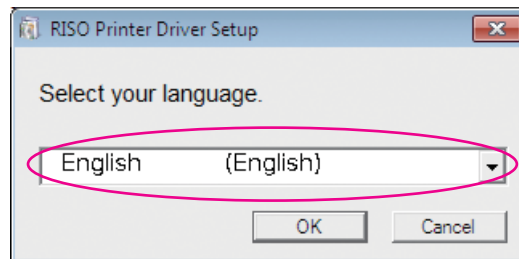

**3**

**Click [Next].**

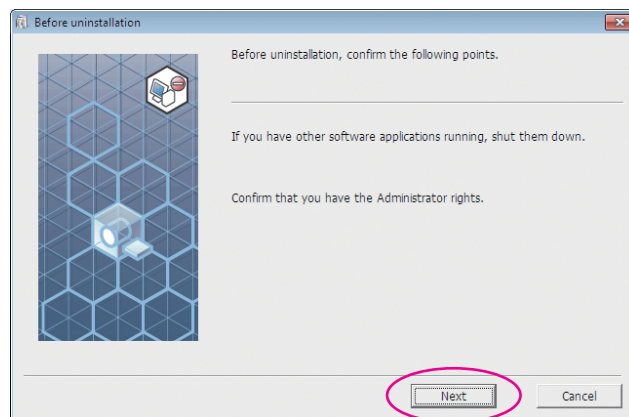

**4**

Select the printer for which the Printer Driver needs to be uninstalled.

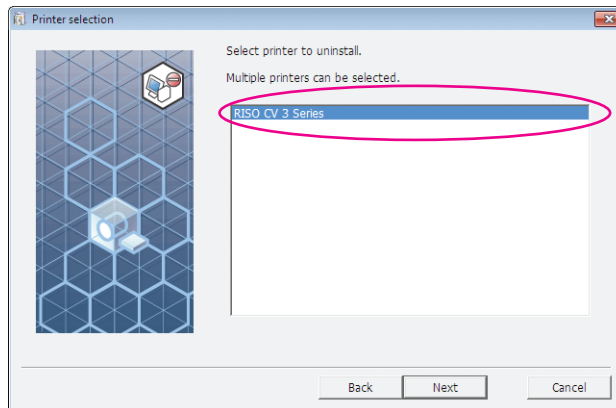
**5**

Click [Next].

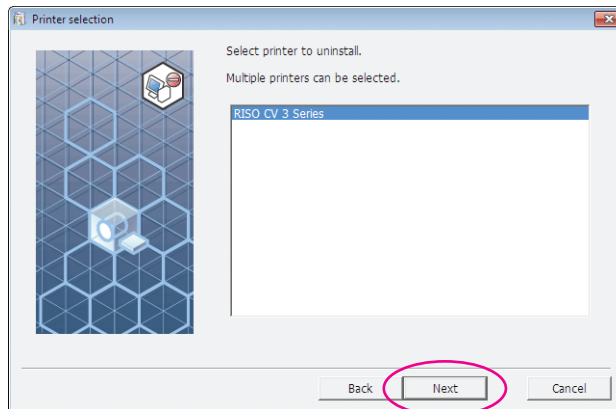
**6**

Click [Uninstall].

When you place a checkmark in the [Uninstall also User's Guide (PDF)] checkbox, the User's Guide (PDF) will also be uninstalled.

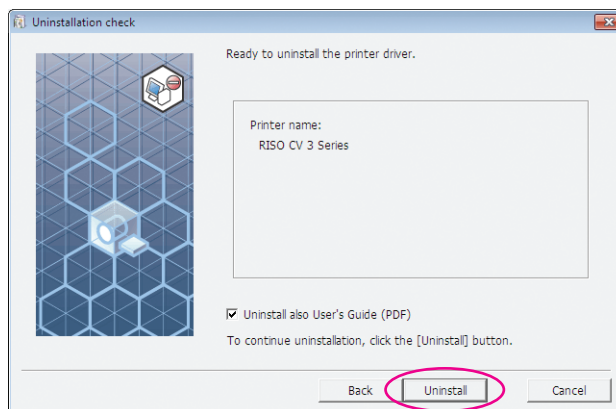

**7**

**Click [Finish].**

When the Printer Driver has been uninstalled, be sure to restart your computer.

When [Reboot the PC now.] is checked, your computer is restarted after [Finish] is clicked.

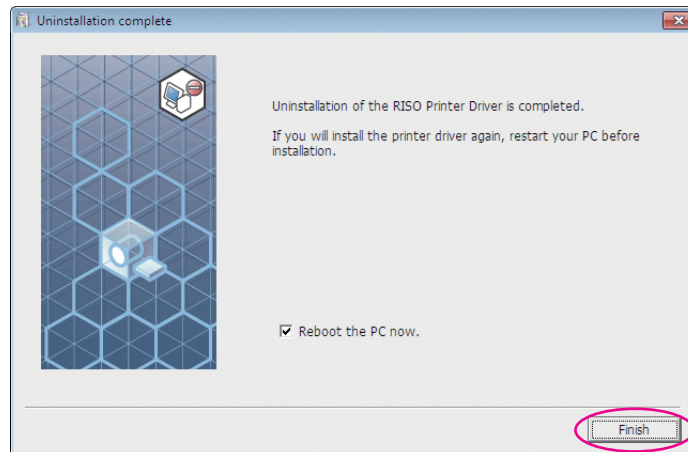



# Manually installing / uninstalling the Printer Driver

The procedure of installing / uninstalling the Printer Driver without using the installer / uninstaller is described here.

<b>For Windows Vista .....</b>	<b>48</b>
<b>■ Manual installation .....</b>	<b>48</b>
In the case of USB cable connection .....	48
In the case of USB Flash Drive output .....	50
<b>■ Manual uninstallation .....</b>	<b>51</b>
<b>For Windows 7 .....</b>	<b>52</b>
<b>■ Manual installation .....</b>	<b>52</b>
In the case of USB cable connection .....	52
In the case of USB Flash Drive output .....	53
<b>■ Manual uninstallation .....</b>	<b>55</b>
<b>For Windows 8/Windows 8.1 .....</b>	<b>56</b>
<b>■ Manual installation .....</b>	<b>56</b>
In the case of USB cable connection .....	56
In the case of USB Flash Drive output .....	57
<b>■ Manual uninstallation .....</b>	<b>59</b>
<b>For Windows 10 .....</b>	<b>60</b>
<b>■ Manual installation .....</b>	<b>60</b>
In the case of USB cable connection .....	60
In the case of USB Flash Drive output .....	61
<b>■ Manual uninstallation .....</b>	<b>63</b>

# For Windows Vista

## ■ Manual installation

### IMPORTANT!

- To install the Printer Driver, it is necessary to log in to Windows with an account with the authority to change system settings (administrator etc.).
- Printer sharing is not supported.

## In the case of USB cable connection

---

- 1** Turn the power of the printer on, and connect the USB cable to the printer.
- 2** Start your computer.
- 3** Connect the USB cable to your computer.
- 4** In the [Found New Hardware] window, select [Locate and install driver software] and then [Don't search online].
- 5** Select [I don't have the disk. Show me other options.], and then [Browse my computer for driver software].
- 6** Insert the [RISO Printer Driver] CD-ROM into your computer.
- 7** In the [Browse] window, select the inf file of the driver to install.  
For Windows Vista (32-bit):(CD-ROM):[Windows32-bit]-[Driver]-[WinVista\_8]-[English]-RISODRV.INF  
For Windows Vista (64-bit):(CD-ROM):[Windows64-bit]-[Driver]-[WinVista\_8]-[English]-RISODRV.INF
- 8** Select the printer in use and click [Next].
- 9** Restart your computer.
- 10** Open [Control Panel]-[Hardware and Sound]-[Printers] in this order, and open the properties of the printer in which the Printer Driver has been installed.

- 11** Click [Print processor] of the [Advanced] tab.
- 12** Select the following print processor from the list and click it.  
In the case of a Windows Vista (32-bit): R36V8NP  
In the case of a Windows Vista (64-bit): R36V6NP
- 13** Select [NT EMF 1.008] from the list of default data types, and click [OK].
- 14** Print the test page.

## In the case of USB Flash Drive output

---

- 1** Open [Control Panel]-[Hardware and Sound]-[Printers] in this order, and select [Add a Printer] to start.
- 2** Click [Add a local printer] of the [Add a Printer] dialog box.
- 3** Create the local port (C:\RISO\RISORINC.prn, etc.).  
**IMPORTANT!**  
You cannot create the local port in the route of the startup drive. Create any folder, and then create the local port in the folder.
- 4** Click [Have Disk], and select the inf file of the driver to install.  
For Windows Vista (32-bit):(CD-ROM):[Windows 32-bit]-[Driver]-  
[WinVista\_8]-[English]-[USB flash]-RISODRV.INF  
For Windows Vista (64-bit):(CD-ROM):[Windows 64-bit]-[Driver]-  
[WinVista\_8]-[English]-[USB flash]-RISODRV.INF
- 5** Select the printer in use, and click [Next].
- 6** Restart your computer.

## ■ Manual uninstallation

- 1** Open [Control Panel]-[Hardware and Sound]-[Printers] in this order, and delete the printer to uninstall.
- 2** From the menu displayed by right-clicking on the margin of the [Printers] folder, select [Run as administrator] and then [Server properties].
- 3** From the [Drivers] tab, select the Printer Driver to uninstall, and click [Remove].
- 4** When the [Remove driver and package] dialog opens, select [Remove driver and driver package] to delete the driver and driver package.

# For Windows 7

## Manual installation

### IMPORTANT!

- To install the Printer Driver, it is necessary to log in to Windows with an account with the authority to change system settings (administrator etc.).
- Printer sharing is not supported.

### In the case of USB cable connection

---

**1**

Turn the power of the printer on, and connect the USB cable to the printer.

**2**

Start your computer.

**3**

Connect the USB cable to your computer.

### IMPORTANT!

Do not proceed to the following steps until [Device driver software was not successfully installed] appears in the task tray.

**4**

Activate [Device Manager].

Click [Start] icon-[Control Panel]-[Hardware and Sound]-[Device Manager].

**5**

Right-click [Other devices]-[(Your printer name)] and then click [Update Driver Software] from the menu that appears.

**6**

Click [Browse my computer for driver software].

**7**

Insert the [RISO Printer Driver] CD-ROM into your computer.

**8**

Click [Browse], select the folder shown below and click [OK].

#### CV3 Series

For Windows 7 (32-bit):(CD-ROM):[Windows 32-bit]-[Driver]-[WinVista\_8]-[English]

For Windows 7 (64-bit):(CD-ROM):[Windows 64-bit]-[Driver]-[WinVista\_8]-[English]

#### CV1200 Series

For Windows 7 (32-bit):(CD-ROM):[Windows 32-bit]-[Driver]-[Windows]-[English]

For Windows 7 (64-bit):(CD-ROM):[Windows 64-bit]-[Driver]-[Windows]-[English]

- 9** Select [(Your printer name)] from the list and click [Next].
- 10** Click [Close] and restart your computer.
- 11** Open [Control Panel]-[Hardware and Sound]-[Devices and Printers] in this order, right-click on the installed printer and click [Printer properties] from the menu that appears.
- 12** Click [Print processor] of the [Advanced] tab.
- 13** Select the following print processor from the list and click it.  
**CV3 Series**  
For Windows 7 (32-bit): R36V8NP  
For Windows 7 (64-bit): R36V6NP  
**CV1200 Series**  
For Windows 7 (32-bit): R36V8OP  
For Windows 7 (64-bit): R36V6OP
- 14** Select [NT EMF 1.008] from the list of default data types, and click [OK].
- 15** Print a test page from the [General] tab.
- 16** Click [OK] to close the window.

## In the case of USB Flash Drive output

### **IMPORTANT!**

USB Flash Driver cannot be used for the CV1200 series.

- 1** Open [Control Panel]-[Hardware and Sound]-[Devices and Printers] in this order, and select [Add a Printer] for starting.
- 2** Click [Add a local printer] of the [Add a Printer] dialog box.
- 3** Create the local port (C:\RISO\RISORINC.prn, etc.).  
**IMPORTANT!**  
You cannot create the local port in the route of the startup drive.  
Create any folder, and then create the local port in the folder.
- 4** Insert the [RISO Printer Driver] CD-ROM into your computer.

**5**

Click **[Have Disk]**.

**6**

In the **[Browse]** window, select the following inf file and click **[OK]**.

For Windows 7 (32-bit):(CD-ROM):[Windows 32-bit]-[Driver]-[WinVista\_8]-  
[English]-[USB flash]-RISODRV.INF

For Windows 7 (64-bit):(CD-ROM):[Windows 64-bit]-[Driver]-[WinVista\_8]-  
[English]-[USB flash]-RISODRV.INF

**7**

Select **[(Your printer name)]** from the list and click **[Next]**.

**8**

Enter the **[Printer name]** and click **[Next]**.

**9**

Click **[Finish]** to close the window.

**10**

Restart your computer.



## ■ Manual uninstallation

- 1** Open [Control Panel]-[Hardware and Sound]-[Devices and Printers] in this order, and delete the printer to uninstall it from the printer folder.
- 2** Click on the existing printer and click [Print server properties] at the top of the window.
- 3** From the [Drivers] tab, select the Printer Driver to uninstall, and click [Remove].
- 4** When the [Remove Driver And Package] dialog opens, select [Remove driver and driver package.] to delete the driver and driver package.

# For Windows 8/Windows 8.1

## Manual installation

### IMPORTANT!

- To install the Printer Driver, it is necessary to log in to Windows with an account with the authority to change system settings (administrator etc.).
- Printer sharing is not supported.

### In the case of USB cable connection

---

- 1** Turn the power of the printer on, and connect the USB cable to the printer.
- 2** Start your computer.
- 3** Connect the USB cable to your computer.
- 4** Activate [Device Manager].  
Open the “Apps” screen and click [Control Panel]-[Hardware and Sound]-[Device Manager].
- 5** Right-click [Other devices]-[(Your printer name)] and then click [Update Driver Software] from the menu that appears.  
**NOTE** If your printer name is not displayed, click [Action]-[Scan for hardware changes].
- 6** Click [Browse my computer for driver software].
- 7** Insert the [RISO Printer Driver] CD-ROM into your computer.
- 8** Click [Browse], select the folder shown below and click [OK].  
**CV3 Series**  
For Windows 8 (32-bit)/Windows 8.1 (32-bit):  
(CD-ROM):[Windows 32-bit]-[Driver]-[WinVista\_8]-[English]  
For Windows 8 (64-bit)/Windows 8.1 (64-bit):  
(CD-ROM):[Windows 64-bit]-[Driver]-[WinVista\_8]-[English]  
**CV1200 Series**  
For Windows 8.1 (32-bit):  
(CD-ROM):[Windows 32-bit]-[Driver]-[Windows]-[English]  
For Windows 8.1 (64-bit):  
(CD-ROM):[Windows 64-bit]-[Driver]-[Windows]-[English]

- 9** Select [(Your printer name)] from the list and click [Next].
- 10** Click [Close] and restart your computer.
- 11** Open [Control Panel]-[Hardware and Sound]-[Devices and Printers] in this order, right-click on the installed printer and click [Printer properties] from the menu that appears.
- 12** Click [Print processor] of the [Advanced] tab.
- 13** Select the following print processor from the list and click it.
  - CV3 Series**
    - For Windows 8 (32-bit)/Windows 8.1 (32-bit): R36V8NP
    - For Windows 8 (64-bit)/Windows 8.1 (64-bit): R36V6NP
  - CV1200 Series**
    - For Windows 8.1 (32-bit): R36V8OP
    - For Windows 8.1 (64-bit): R36V6OP
- 14** Select [NT EMF 1.008] from the list of default data types, and click [OK].
- 15** Print a test page from the [General] tab.
- 16** Click [OK] to close the window.

## In the case of USB Flash Drive output

### **IMPORTANT!**

USB Flash Driver cannot be used for the CV1200 series.

- 1** Open [Control Panel]-[Hardware and Sound]-[Devices and Printers] in this order, and select [Add a Printer] for starting.
- 2** Click [Add a local printer or network printer with manual settings] of the [Add a Printer] dialog box.
- 3** Create the local port (C:\RISO\RISORINC.prn, etc.).

### **IMPORTANT!**

You cannot create the local port in the route of the startup drive. Create any folder, and then create the local port in the folder.

- 4** Insert the [RISO Printer Driver] CD-ROM into your computer.
- 5** Click [Have Disk].
- 6** In the [Browse] window, select the following inf file and click [OK].  
For Windows 8 (32-bit)/Windows 8.1 (32-bit):  
(CD-ROM):[Windows 32-bit]-[Driver]-[WinVista\_8]-[English]-[USB flash]-RISODRV.INF  
For Windows 8 (64-bit)/Windows 8.1 (64-bit):  
(CD-ROM):[Windows 64-bit]-[Driver]-[WinVista\_8]-[English]-[USB flash]-RISODRV.INF
- 7** Select [(Your printer name)] from the list and click [Next].
- 8** Enter the [Printer name] and click [Next].
- 9** Click [Finish] to close the window.
- 10** Restart your computer.

## ■ Manual uninstallation

- 1** Open [Control Panel]-[Hardware and Sound]-[Devices and Printers] in this order, and delete the printer to uninstall from the printer folder.
- 2** Click on the existing printer and click [Print server properties] at the top of the window.
- 3** From the [Drivers] tab, select the Printer Driver to uninstall, and click [Remove].
- 4** When the [Remove Driver And Package] dialog opens, select [Remove driver and driver package.] to delete the driver and driver package.

# For Windows 10

## Manual installation

### IMPORTANT!

- To install the Printer Driver, it is necessary to log in to Windows with an account with the authority to change system settings (administrator etc.).
- Printer sharing is not supported.

### In the case of USB cable connection

---

**1**

Turn the power of the printer on, and connect the USB cable to the printer.

**2**

Start your computer.

**3**

Connect the USB cable to your computer.

**4**

Activate [Device Manager].

Right-click on the [Start] icon and click [Control Panel]-[Hardware and Sound]-[Device Manager].

**5**

Right-click [Other devices]-[(Your printer name)] and then click [Update Driver Software] from the menu that appears.

**NOTE** If your printer name is not displayed, click [Action]-[Scan for hardware changes].

**6**

Click [Browse my computer for driver software].

**7**

Insert the [RISO Printer Driver] CD-ROM into your computer.

**8**

Click [Browse], select the folder shown below and click [OK].

#### CV3 Series

For Windows 10 (32-bit):(CD-ROM):[Windows 32-bit]-[Driver]-[WinVista\_8]-[English]

For Windows 10 (64-bit):(CD-ROM):[Windows 64-bit]-[Driver]-[WinVista\_8]-[English]

#### CV1200 Series

For Windows 10 (32-bit):(CD-ROM):[Windows 32-bit]-[Driver]-[Windows]-[English]

For Windows 10 (64-bit):(CD-ROM):[Windows 64-bit]-[Driver]-[Windows]-[English]

- 9** Select [(Your printer name)] from the list and click [Next].
- 10** Click [Close] and restart your computer.
- 11** Open [Control Panel]-[Hardware and Sound]-[Devices and Printers] in this order, right-click on the installed printer and click [Printer properties] from the menu that appears.
- 12** Click [Print processor] of the [Advanced] tab.
- 13** Select the following print processor from the list and click it.  
**CV3 Series**  
For Windows 10 (32-bit): R36V8NP  
For Windows 10 (64-bit): R36V6NP  
**CV1200 Series**  
For Windows 10 (32-bit): R36V8OP  
For Windows 10 (64-bit): R36V6OP
- 14** Select [NT EMF 1.008] from the list of default data types, and click [OK].
- 15** Print a test page from the [General] tab.
- 16** Click [OK] to close the window.

## In the case of USB Flash Drive output

### **IMPORTANT!**

USB Flash Driver cannot be used for the CV1200 series.

- 1** Open [Control Panel]-[Hardware and Sound]-[Devices and Printers] in this order, and select [Add a Printer] for starting.
- 2** Click [Add a local printer or network printer with manual settings] of the [Add a Printer] dialog box.
- 3** Create the local port (C:\RISO\RISORINC.prn, etc.).

### **IMPORTANT!**

You cannot create the local port in the route of the startup drive.  
Create any folder, and then create the local port in the folder.

- 4** Insert the [RISO Printer Driver] CD-ROM into your computer.
- 5** Click [Have Disk].
- 6** In the [Browse] window, select the following inf file and click [OK].  
For Windows 10 (32-bit):(CD-ROM):[Windows 32-bit]-[Driver]-[WinVista\_8]-  
[English]-[USB flash]-RISODRV.INF  
For Windows 10 (64-bit):(CD-ROM):[Windows 64-bit]-[Driver]-[WinVista\_8]-  
[English]-[USB flash]-RISODRV.INF
- 7** Select [(Your printer name)] from the list and click [Next].
- 8** Enter the [Printer name] and click [Next].
- 9** Click [Finish] to close the window.
- 10** Restart your computer.



# Manual uninstallation

- 1** Open [Control Panel]-[Hardware and Sound]-[Devices and Printers] in this order, and delete the printer to uninstall from the printer folder.
- 2** Click on the existing printer and click [Print server properties] at the top of the window.
- 3** From the [Drivers] tab, select the Printer Driver to uninstall, and click [Remove].
- 4** When the [Remove Driver And Package] dialog opens, select [Remove driver and driver package.] to delete the driver and driver package.



# Appendix

Troubleshooting Tips .....	65
Error Message on PC's Display .....	65
Operation Problems .....	66

# Troubleshooting Tips

---

## Error Message on PC's Display

Perform the actions given below if the following error messages appear in the PC's display.

### Message

The printer is not ready for printing.  
(The device is not ready.)

### Description and Action

This message appears when your RISO printer requires paper or it is not connected to your computer properly.

**Action** Replenish paper or check your RISO printer and the printer cable for poor connection, and then restart printing.

This message also appears when the memory of your RISO printer becomes full during data transmission because the size of the document data concerned is too large.

**Action** Reduce the file size of the document data concerned or increase the value of the [Timeout] setting in your computer system, and then restart printing.

---

Cannot print because an error is found in the current printer settings.

This message appears if the printer settings (paper size, print orientation, etc.) in the application software and the Printer Driver do not match.

**Action** Change the printer settings in the application software to make them identical to those in the Printer Driver or vice versa.

---

## Operation Problems

Check your system setup as given below if you encounter the following operation problems. Contact your service representative for help if you cannot solve the problem.

### No Printout

---

#### Problem

Your RISO printer is not receiving data from your computer even after the print job finishes in the application software.

#### Cause / Condition and Action

- Your computer is not securely connected to your RISO printer.

**Action** Connect the printer cable to both your computer and your RISO printer securely.

- The [RISO...] Printer Driver is not selected.

**Action** Select it and reprint.

- [Printing] is displayed as the printer status when you open the [RISO...] printer monitor window.

**Action** Wait until the printer status display changes in the [RISO...] printer monitor window.

---

### Problem

Your RISO printer cannot finish processing the current document data.

### Cause / Condition and Action

- The printer cable was removed just after a print job started in the application software. ([Printing] is displayed when you open the [RISO...] printer monitor window in this case.)

**Action** ▶ Reconnect the cable and cancel the current job in the [RISO...] printer monitor window. Then turn off the main power switch of your RISO printer. After approximately 10 seconds, turn it on again.

- [Pause] is displayed as the printer status when you open the [RISO...] printer monitor window.

**Action** ▶ Click [Restart] in the [Document] menu in the [RISO...] printer monitor window.

- The printer settings (paper size, print orientation, etc.) in the application software and in the Printer Driver do not match.

**Action** ▶ Change the printer settings in the application software to make them identical to those in the Printer Driver or vice versa, and repeat the print job from the application software.

- The print job has been canceled before completion in the application software on your computer.

**Action** ▶ Turn off the main power switch of your RISO printer. After approximately 10 seconds, turn it on again.

---

Your RISO printer won't start making master when the documentation data is transmitted from your computer or your RISO printer won't start printing after making master.

- If you set the [Auto-process] to a setting other than "ON", the process stops in operation in order to wait for instructions.

**Action** ▶ Press Start key on your RISO printer. The next process starts.

## Unexpected Print Result \_\_\_\_\_

Problem	Cause / Condition and Action
Graphics cannot be printed properly.	<ul style="list-style-type: none"><li data-bbox="676 371 1437 443"><input type="checkbox"/> The current [RISO...] printer driver was not selected as active when editing graphics.</li><li data-bbox="676 465 1437 607"><b>Action</b> Select the current [RISO...] Printer Driver and edit graphics again because graphics may not print properly if they are edited with another Printer Driver selected.</li><li data-bbox="676 629 1437 701"><input type="checkbox"/> The specified custom paper size was so large that unexpected margins were assigned on a page.</li><li data-bbox="676 723 1437 797"><b>Action</b> Select another paper size or specify the custom paper size within the valid range.</li></ul>
Images are reduced unexpectedly.	<ul style="list-style-type: none"><li data-bbox="676 875 1437 947"><input type="checkbox"/> Did you use the Printer Driver corresponding to your RISO printer?</li><li data-bbox="676 969 1437 1077"><b>Action</b> If the name of your RISO printer is different from the model name of your Printer Driver, the document data cannot be printed out correctly.</li></ul>
Some fonts cannot be printed properly.	<ul style="list-style-type: none"><li data-bbox="676 1155 1437 1227"><input type="checkbox"/> The [Use Printer Font] option is selected in the application software.</li><li data-bbox="676 1249 1437 1312"><b>Action</b> Cancel the [Use Printer Font] option in the application software.</li></ul>
The page image is not centered or is clipped at an edge.	<ul style="list-style-type: none"><li data-bbox="676 1391 1437 1469"><input type="checkbox"/> The paper size setting in the application software is not identical to that in the Printer Driver.</li><li data-bbox="676 1491 1437 1525"><b>Action</b> Make both paper size settings identical.</li><li data-bbox="676 1547 1437 1619"><input type="checkbox"/> The print area specified in the application software is beyond the maximum print area of your RISO printer.</li><li data-bbox="676 1641 1437 1749"><b>Action</b> Increase the border margins in the application software to contain the page image within the printable area of your RISO printer.</li><li data-bbox="676 1771 1437 1843"><input type="checkbox"/> There is something wrong with the Drum (Cylinder) in your RISO printer.</li><li data-bbox="676 1865 1437 1939"><b>Action</b> Check your RISO printer, referring to the dedicated user's guide.</li></ul>

## Unexpected Action \_\_\_\_\_

### Problem

Your RISO printer repeats the master-making process for each copy of the identical page.

### Cause / Condition and Action

- The [Collated] check box is selected in the [Print] dialog box in the application software.

**Action** > Cancel the current print job on your computer and turn off the main power switch of your RISO printer. After approximately 10 seconds, turn it on again. Always cancel the [Collate Copies] or [Collated] option in the [Print] dialog box when starting a print job.

---

Original data cannot be output to the USB Flash Drive.

- Are you using the Printer Driver for USB Flash Drive?  
There are two types of Printer Drivers. To output to a USB Flash Drive, install the USB flash-via-Printer Driver. Data cannot be output to a USB Flash Drive using an ordinary Printer Driver. ([Page 14](#))
  - Are you using a USB Flash Drive formatted for RISO folders?  
Create a folder just for RISO files in the USB Flash Drive. ([Page 20](#))
-

## Unable to Specify Settings \_\_\_\_\_

### Problem

A name cannot be entered in the dialog box to register the custom paper size.

### Cause / Condition and Action

The name is too long for the corresponding field.

**Action** Names can be up to 30 characters long.

---

A desired value cannot be entered in the corresponding fields to register the custom paper size.

The value does not fall within the range.

**Action** Enter values within the valid ranges into the relevant fields.

---

The custom paper size cannot be registered in the [RISO...] printer driver.

The relevant dialog box was not closed correctly.

**Action** Click [OK] on [Environment] tab after closing the [Custom paper entry] dialog box.  
([Page 26](#))

---

The specified custom paper size cannot be selected in the application software.

[Custom] is not selected in the [Paper Size] option in the [Properties] dialog box of the Printer Driver.

**Action** Select [Custom] in the [Paper Size] option.

[Paper Size: Custom] cannot be selected in the [Printer Setup] dialog box in the application software.

**Action** Specify a standard paper size which is larger than the specified custom one.

---





